

# HOW TO ACTIVATE A STUDENT EMAIL

1. You will need to download the Duo Mobile app from your preferred App Store.

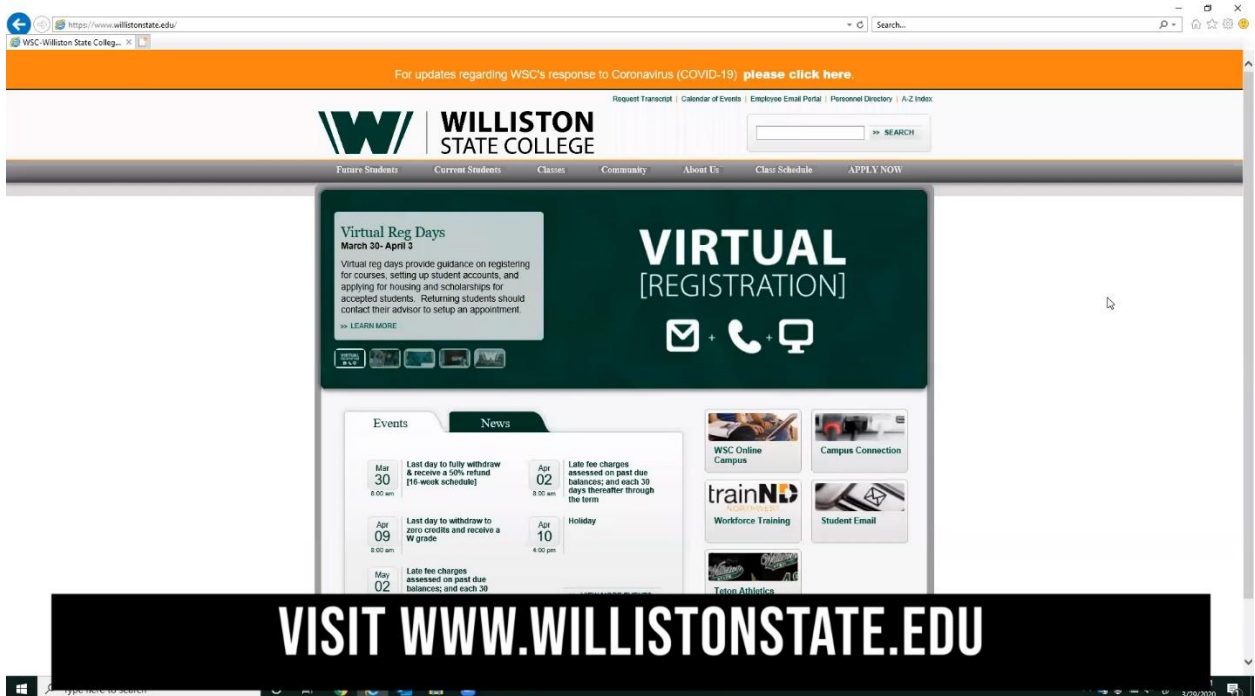

2.



3.

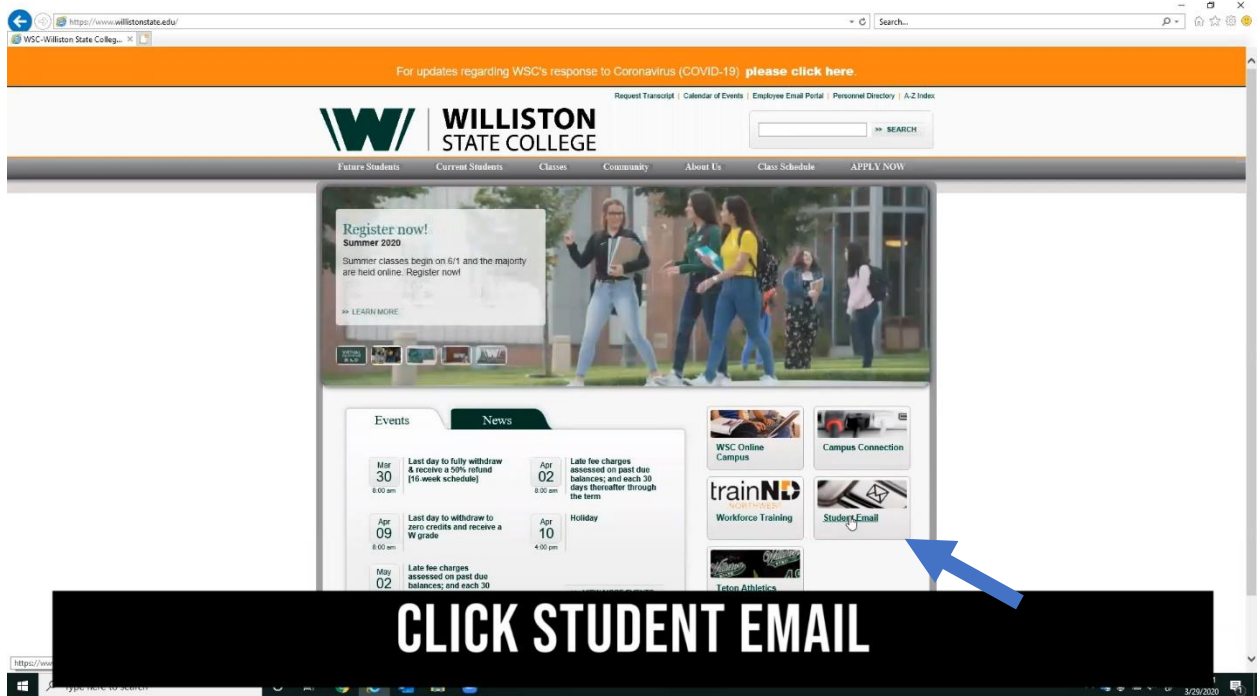

4.



5.

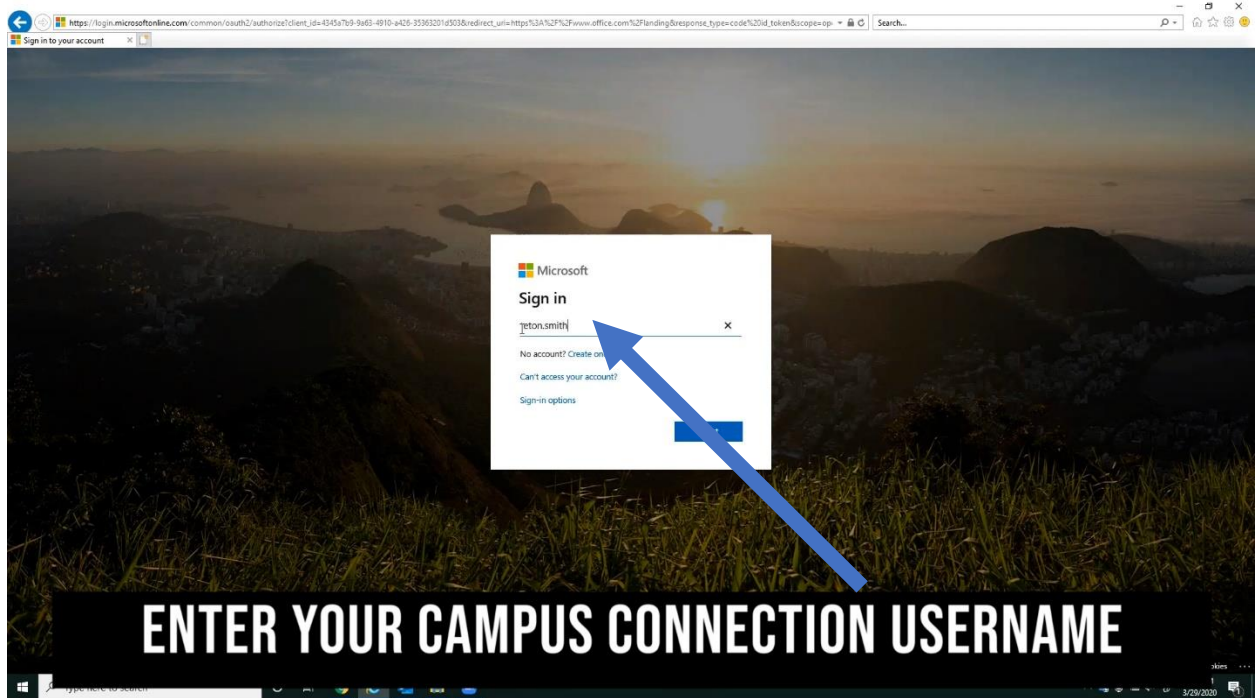

**ENTER YOUR CAMPUS CONNECTION USERNAME**

A username is typically a variation of firstname.lastname

For your email username it will be firstname.lastname@ndus.edu

6.

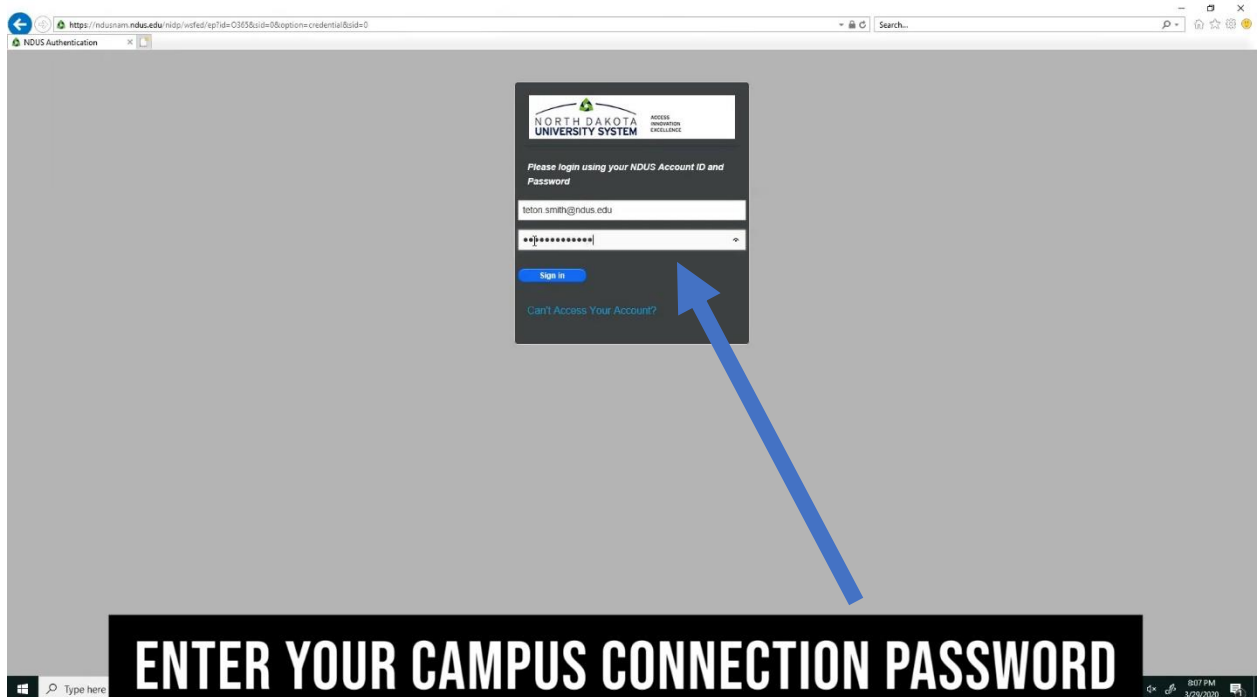

**ENTER YOUR CAMPUS CONNECTION PASSWORD**

7.

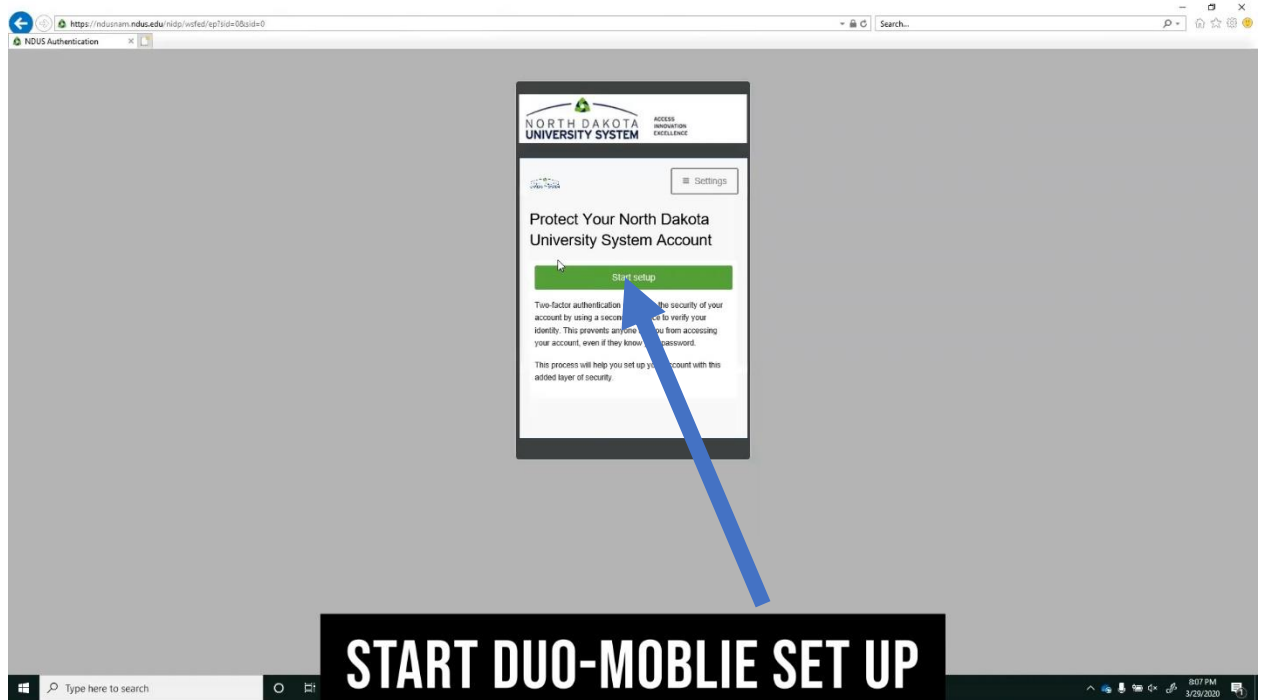

8.

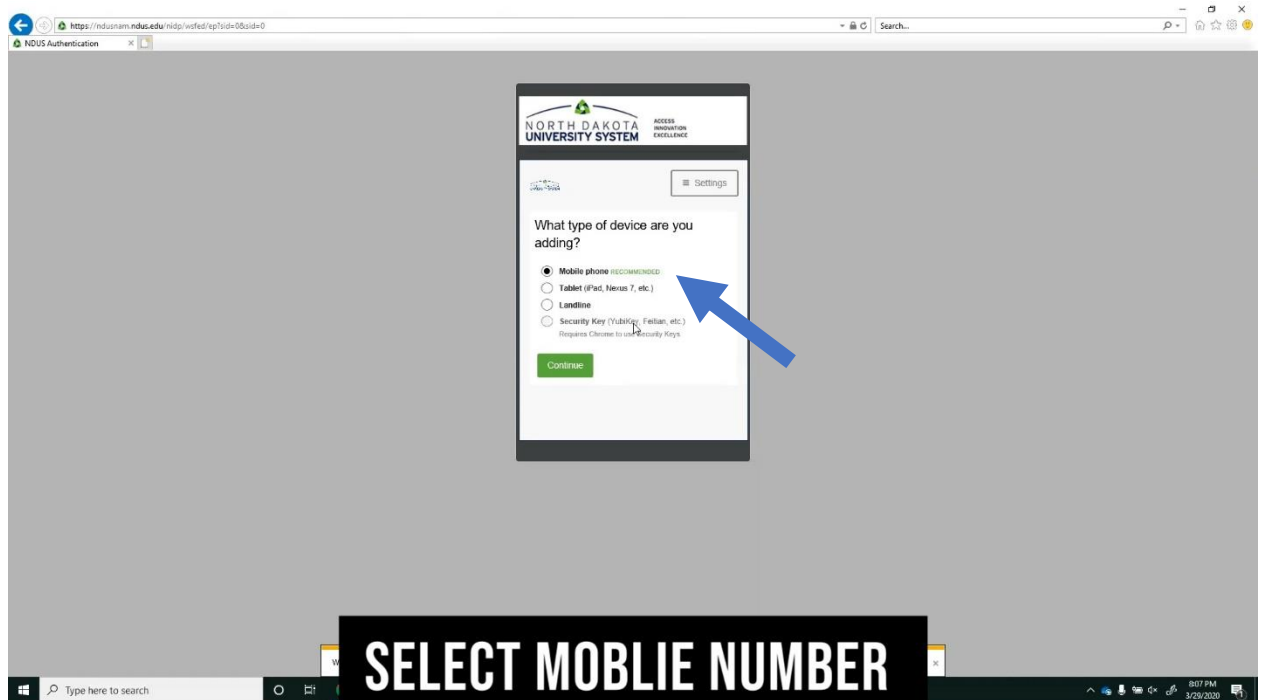

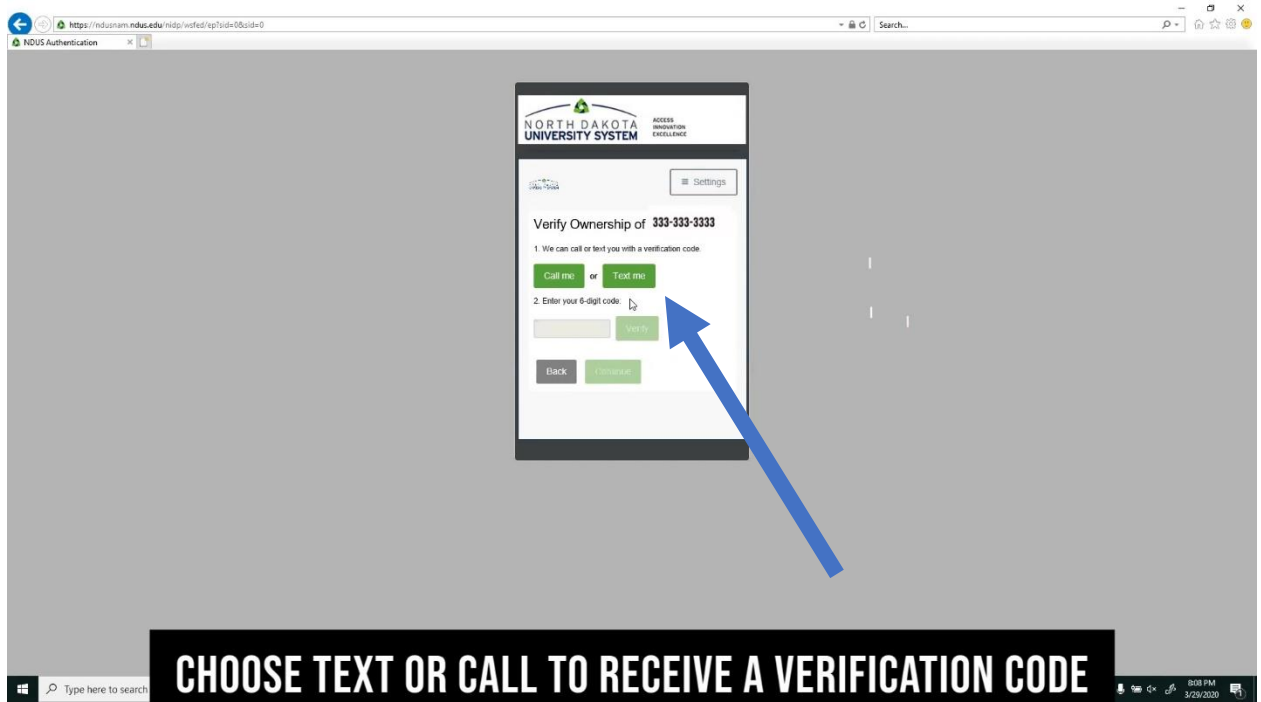
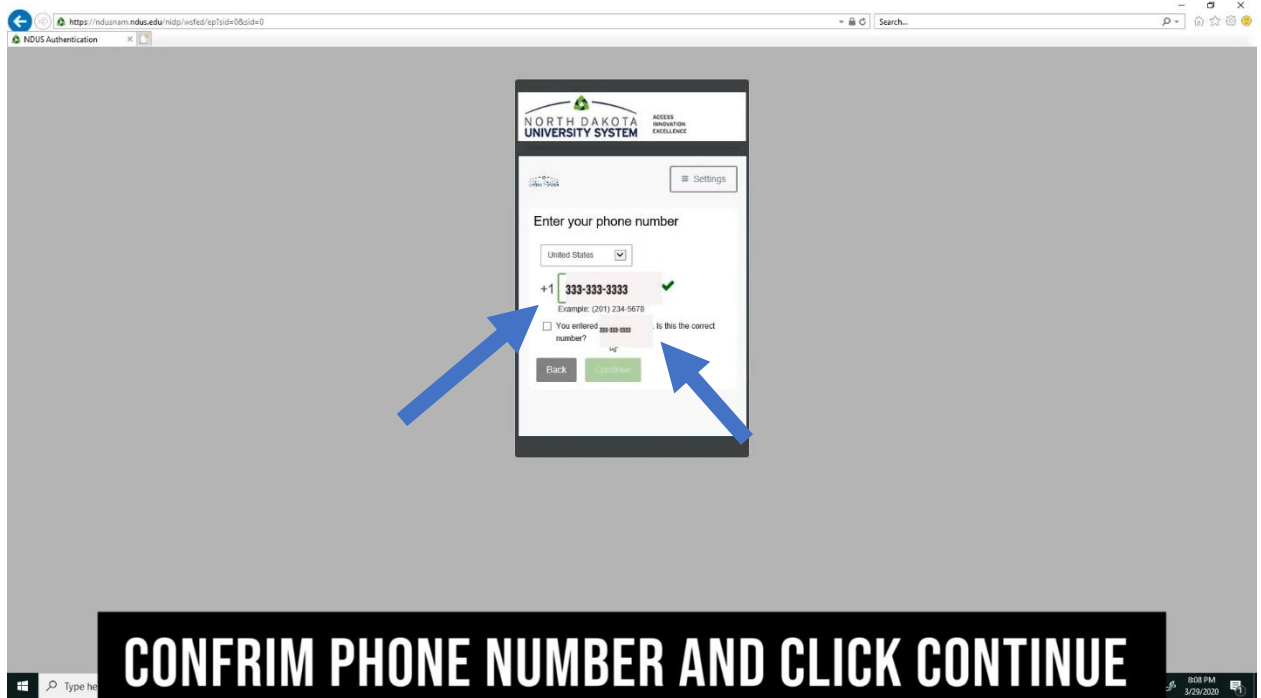

11.

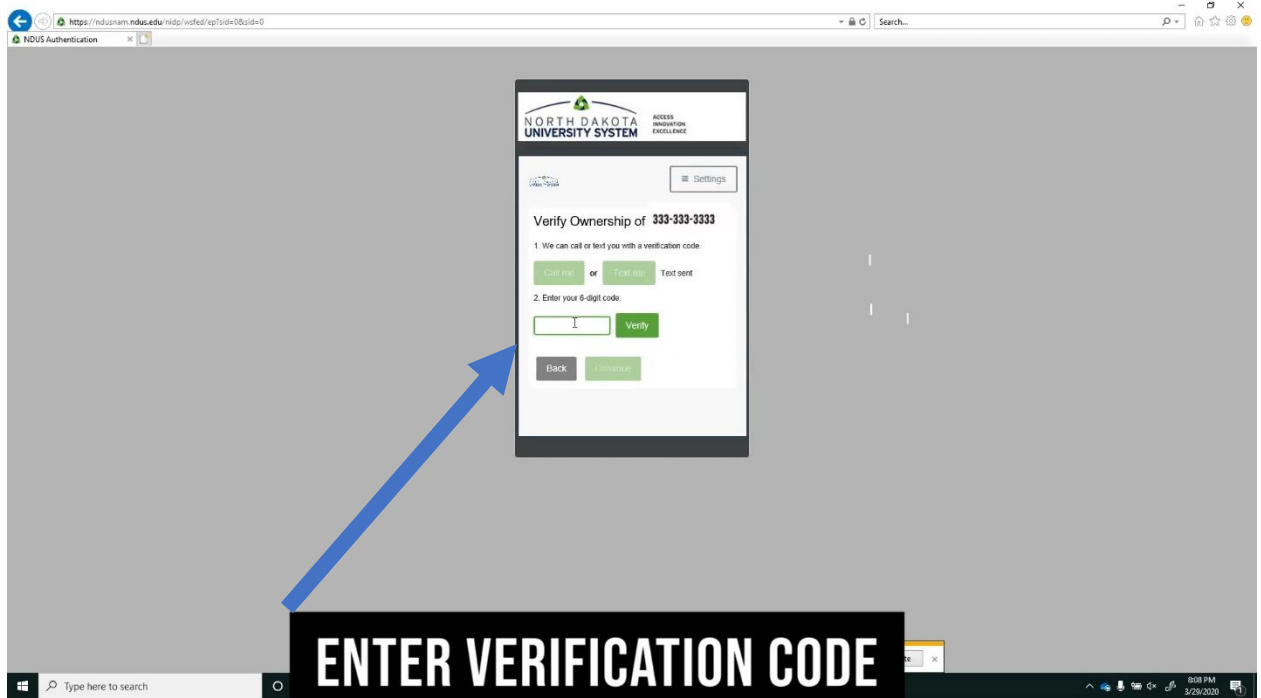

12.

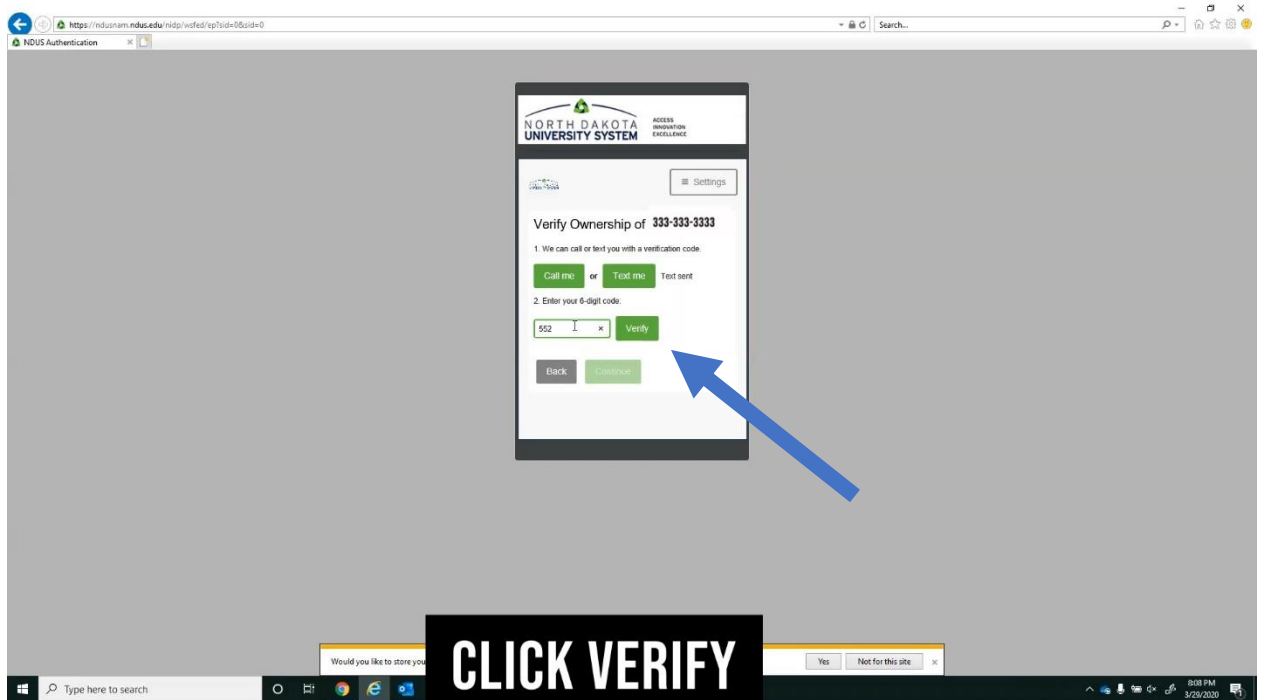

13.

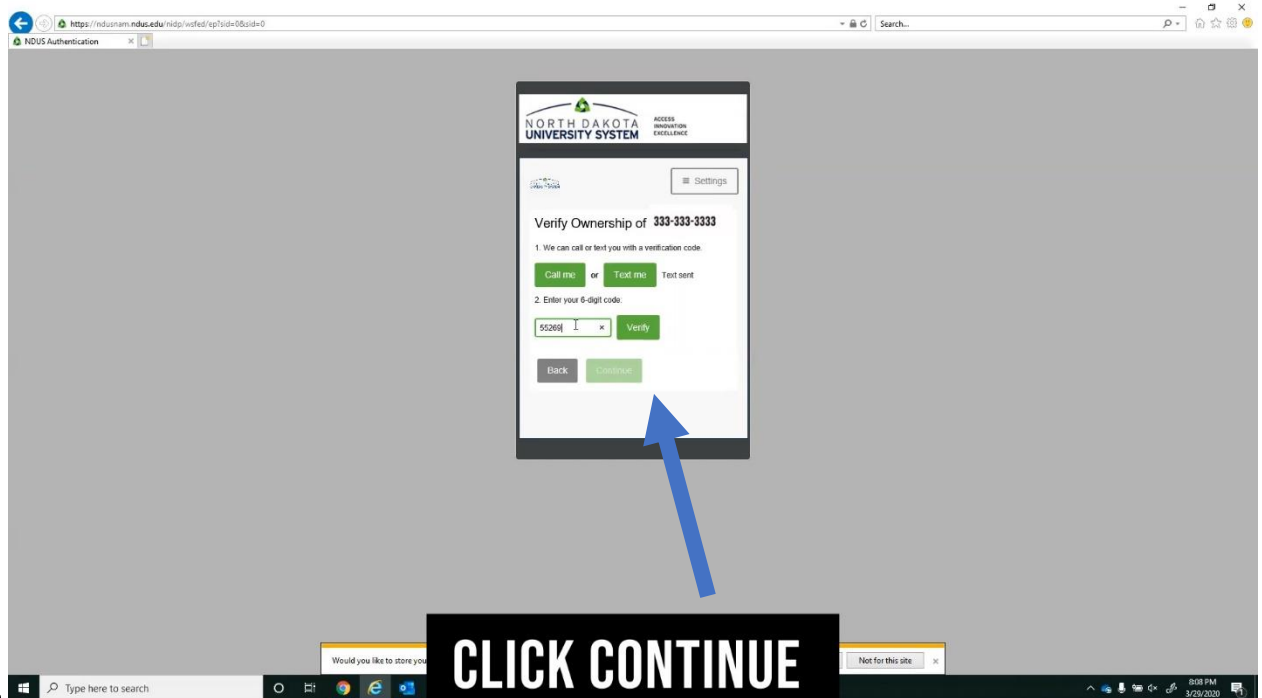

14.

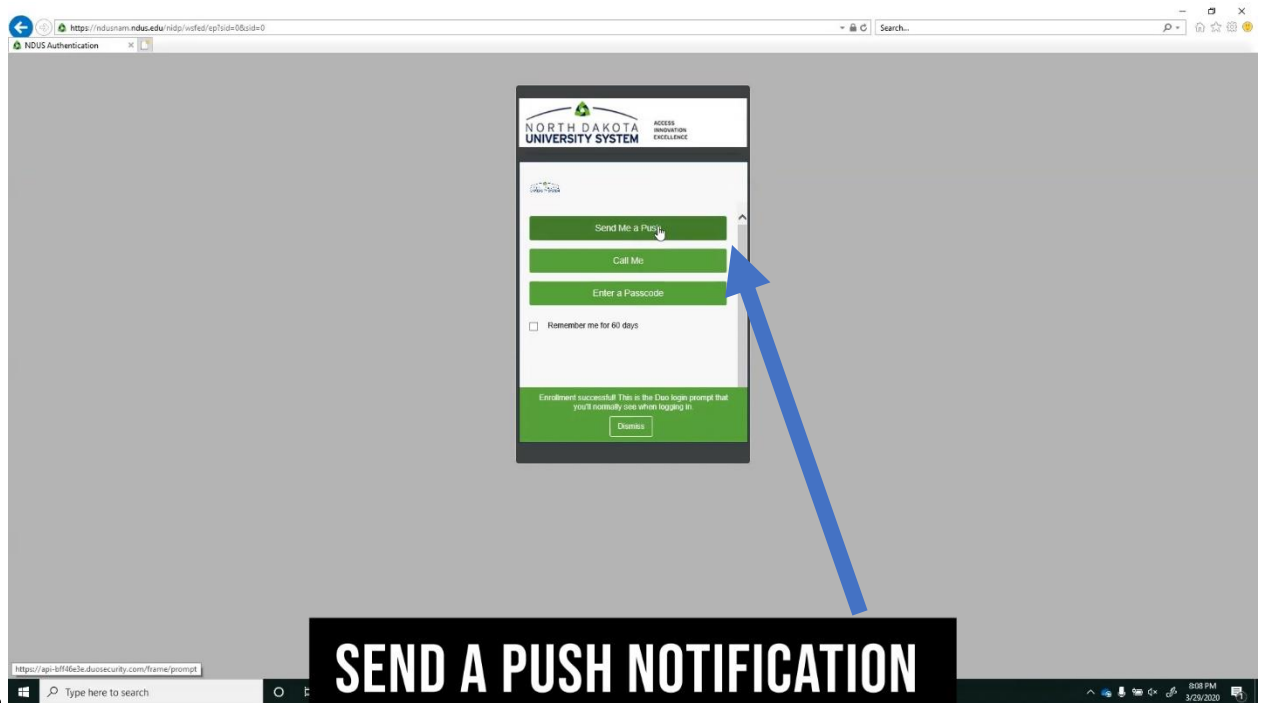

15.

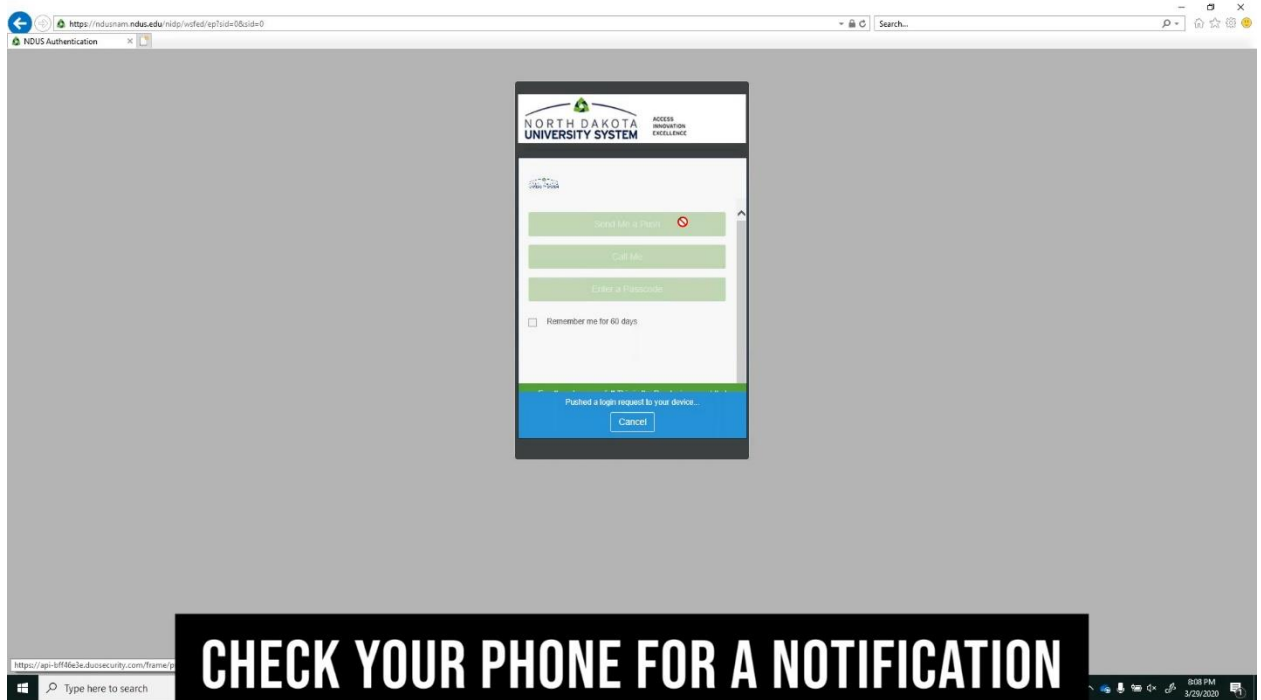

16.

